

Filter housings for out breathing and make-up air filtration on sterile storage tanks or transport vessels.

Donaldson® P-BE vent filter housings are developed for sterile ventilation of stationary and mobile storage tanks used in food, beverage, pharmaceutical, chemical and other industries. P-BE vent housings:

- Are available in 12 different sizes with flow rates ranging from 1 to 1200 scfm
- Have MTRs available upon request
- Are offered with Tri-Clamp or ANSI Flange connection
- Have a Tri-Clamp body closure on single element housings and a tie rod closure on multi-element housings for easy element change out



P-BE

CHOOSE THE FILTER TO SUIT YOUR APPLICATION

P-BE vent filter housings are usually used in conjunction with our P-SRF V process sterile air filter element to ensure sterile ventilation with very little pressure drop or air resistance. It can also be used with other filter elements such as LifeTec™ PT N or the P-SRF X to meet your specific requirements.

SPECIFICATIONS

Tri-Clamp

Model	Housing Material	Gasket	Connection Size	Int. Surface Finish	Maximum Operating Temperature	MTR Included	Element	Part Number
0006	316L SS	EPDM	1-1/2"	RA 63	390°F	Yes	03/10, UF, Qty 1	AG1252829
0027							05/25, UF, Qty 1	AG1252830
0032			2"				05/30, UF, Qty 1	AG1252831
0072							10/30, UF, Qty 1	AG1252832
0144			3"				20/30, UF, Qty 1	AG1252833
0192							30/30, UF, Qty 1	AG1252834

Flange

Model	Housing Material	Gasket	Connection Size	Int. Surface Finish	Maximum Operating Temperature	MTR Included	Element	Part Number
0006	316L SS	EPDM	1"	RA 63	390°F	Yes	03/10, UF, Qty 1	AG1252835
0027			1-1/2"				05/25, UF, Qty 1	AG1252836
0032							05/30, UF, Qty 1	AG1252837
0072			2"				10/30, UF, Qty 1	AG1252838
0144			2-1/2"				20/30, UF, Qty 1	AG1252839
0192							30/30, UF, Qty 1	AG1252840
0432			304 SS				N/A	1"
0576	30/30, UF, Qty 3	1C101574						
0768	30/30, UF, Qty 4	1C102966						
1152	30/30, UF, Qty 6	1C102719						

DIMENSIONS

Tri-Clamp

Model	Capacity (scfm)	Weight* (lbs)	Dimensions (inches)					Element	Part Number
			A	B	C (Connection Pipe OD)	D (Clearance Height)	E (Connection Flange OD)		
0006	10	3.0	4.65	3.35	1.5	3.5	1.99	03/10, UF, Qty 1	AG1252829
0027	16	4.5	6.98	4.09	1.5	5.5	1.99	05/25, UF, Qty 1	AG1252830
0032	24	5.0	7.89	4.50	2.0	6.5	2.52	05/30, UF, Qty 1	AG1252831
0072	48	6.5	12.46	4.50	2.0	11.5	2.52	10/30, UF, Qty 1	AG1252832
0144	102	11.5	21.77	5.08	3.0	20.5	3.58	20/30, UF, Qty 1	AG1252833
0192	152	15.0	31.81	5.08	3.0	30.5	3.58	30/30, UF, Qty 1	AG1252834

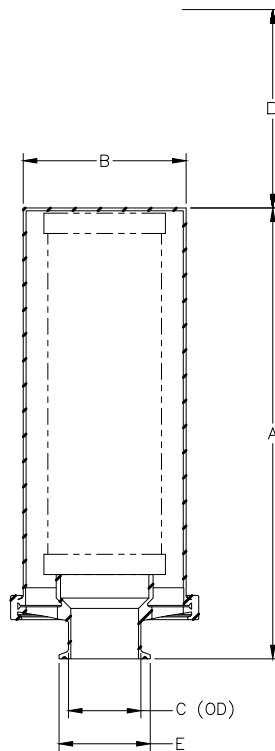

Flange

Model	Capacity (scfm)	Weight* (lbs)	Dimensions (inches)					Element	Part Number
			A	B	C (Connection Pipe OD)	D (Clearance Height)	E (Connection Flange OD)		
0006	10	4.5	6.36	3.35	1.0	3.5	4.25	03/10, UF, Qty 1	AG1252835
0027	16	7.5	8.78	4.09	1.5	5.5	5.00	05/25, UF, Qty 1	AG1252836
0032	24	8.0	9.29	4.50	1.5	6.5	5.00	05/30, UF, Qty 1	AG1252837
0072	48	18.0	14.11	4.50	2.0	11.5	6.00	10/30, UF, Qty 1	AG1252838
0144	102	20.5	23.67	5.08	2.5	20.5	7.00	20/30, UF, Qty 1	AG1252839
0192	152	24.0	33.71	5.08	2.5	20.5	7.00	30/30, UF, Qty 1	AG1252840
0432	247	41.0	29.00	8.70	4.0	23.0	9.00	20/30, UF, Qty 3	1C099413
0576	371	46.0	39.00	8.70	4.0	33.0	9.00	30/30, UF, Qty 3	1C101574
0768	494	50.0	39.00	10.80	6.0	33.0	11.00	30/30, UF, Qty 4	1C102966
1152	742	79.0	39.00	12.80	6.0	33.0	11.00	30/30, UF, Qty 6	1C102719

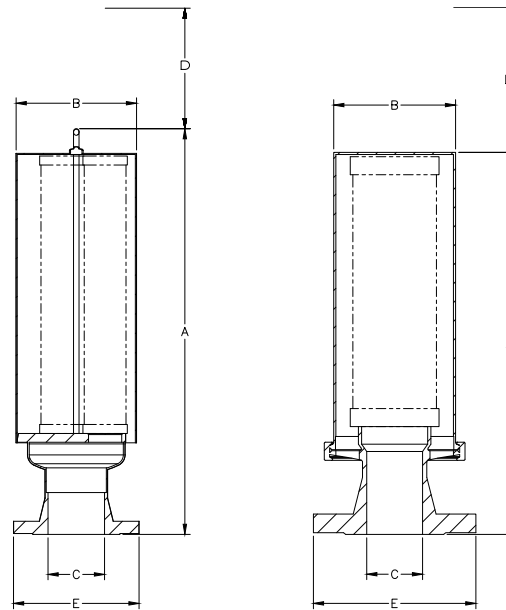

Important Notice

Many factors beyond the control of Donaldson can affect the use and performance of Donaldson products in a particular application, including the conditions under which the product is used. Since these factors are uniquely within the user's knowledge and control, it is essential the user evaluate the products to determine whether the product is fit for the particular purpose and suitable for the user's application. All products, specifications, availability and data are subject to change without notice, and may vary by region or country.



Donaldson Company, Inc.
Minneapolis, MN

donaldson.com
shop.donaldson.com

Australasia 61-02-4350-2066
marketing.australia@donaldson.com

Brazil 55-11-4894-6035
vendas.brasil@donaldson.com

China 86-400-921-7032
info.cn@donaldson.com

EMEA 49-2129-569-0
cap-europe@donaldson.com

India 91-124-4807-400
indiainquiries@donaldson.com

Japan 81-42-540-4123
ndl-ultrafilter-web@donaldson.com

Korea 82-2-517-3333
cap-kr@donaldson.com

Latin America 52-449-300-2442
industrialair@donaldson.com

North America 800-543-3634
processfilters@donaldson.com

South Africa 27-11-997-6000
samarketing@donaldson.com

Southeast Asia 65-6311-7373
sea.salesenquiry@donaldson.com

F117009 ENG (04/20) P-BE Tank Vent Filter Housings

© 2018 Donaldson Co., Inc. All Rights Reserved. Donaldson and the color blue are marks of Donaldson Company, Inc. All other marks belong to their respective owners. (Contains Donaldson proprietary technology.)